

**Architectural Series, Fire Protection Cabinet, Cosmopolitan - C1037F17**  
**FE CABINET, COSMOPOLITAN, 3" RT, FULL VIEW, CLR TEMP, CRS TUB, SS#4 DR/TRM, 10 TUB**

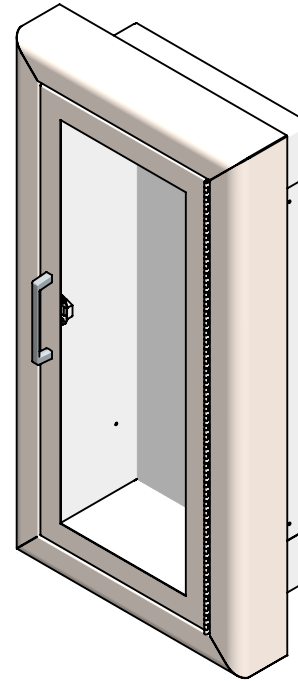
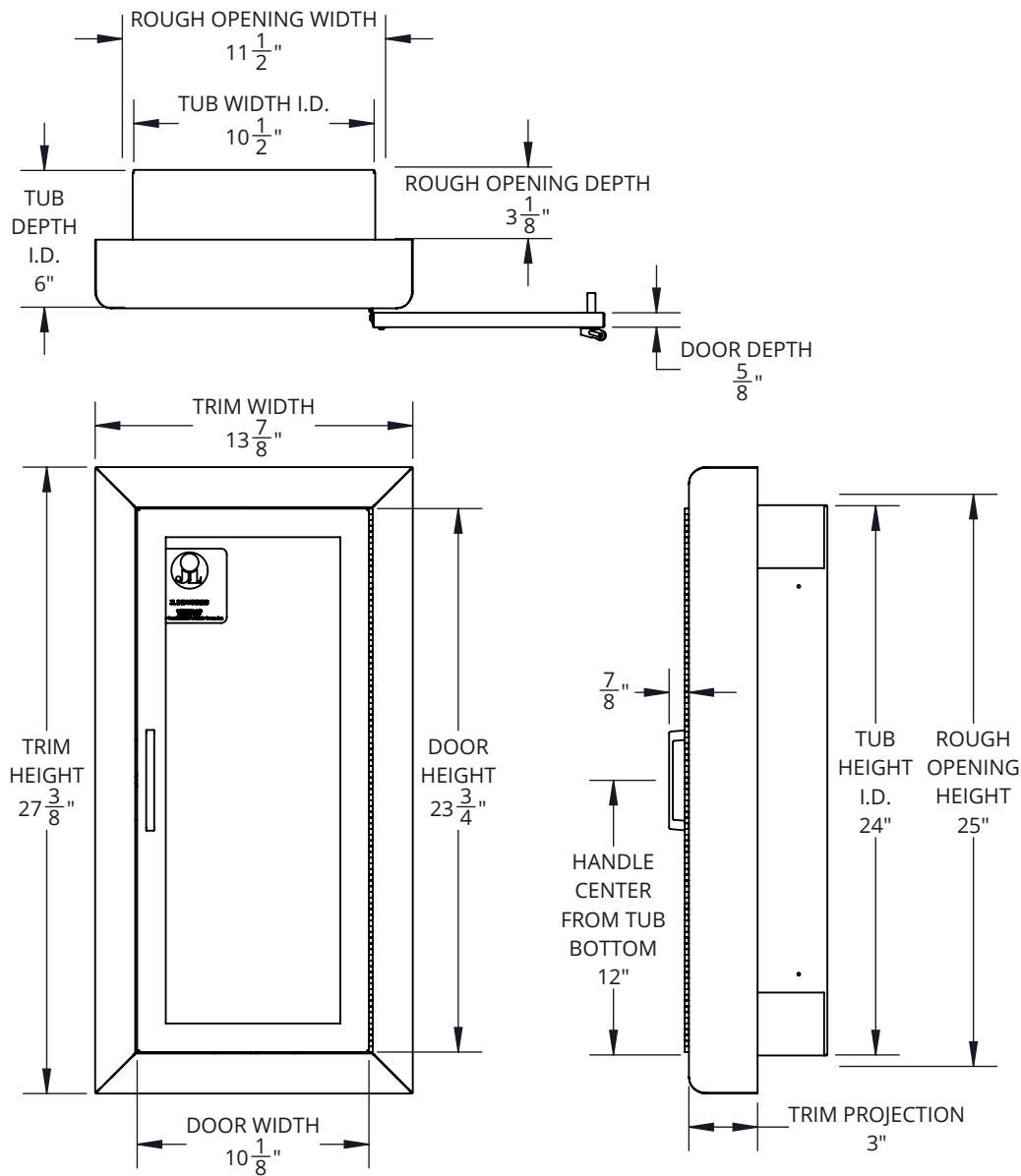

**SPECIFICATIONS:**

- Tub Material:** 24 gauge galvanized steel
- Trim Material & Style:** 18 gauge stainless steel, semi-recessed 3" rolled edge
- Door Material & Style:** 20 gauge stainless steel, full view
- Glazing:**  $\frac{1}{8}$ " clear tempered glass ( $8\frac{1}{2}$ " x  $22\frac{3}{4}$ ")
- Finish:** Satin door and trim, painted white tub
- Hinge:** Continuous hinge opens door 180 degrees, 20 gauge stainless steel
- Hardware:** Zinc plated pull handle, roller catch, glass clips & screws
- Rough Opening:**  $11\frac{1}{2}$ " x  $25$ " x  $3\frac{1}{8}$ "
- Fire Rating:** Not rated
- ADA Compliant:** Cabinet meets 4" maximum protrusion, locate handle maximum 48" above floor
- Compatible Extinguisher:** Cosmic 2.5lb. - 10lb., Galaxy 2.5lb - 10lb., Mercury 2.5lb. - 5lb., Sentinel 5lb.

**MODEL # BREAKDOWN:**

- C — Product Line: Fire protection, cabinet
- 10 — Tub Size:  $10\frac{1}{2}$ " x  $24$ " x  $6$ "
- 3 — Trim and Door Material: SS, satin finish
- 7 — Trim Style: Semi-recessed 3" rolled edge
- F — Door Style: Full view, pull handle, roller catch
- 17 — Door Glazing:  $\frac{1}{8}$ " clear tempered glass

**REPLACEMENT PARTS:**

- Tub: TUB-10-PP
- Trim: T-1037
- Door: D-103F
- Glazing: G10F17
- Hardware Pack: HPFPUS

**MODEL #: C1037F17**



800-554-6077  
 sales@activarcpg.com  
 www.activarcpg.com

9702 Newton Ave S. Bloomington, MN 55431 | Many Locations Nationwide

Distributor:		Project:
Contractor:		Approved By:
Date:	Quantity:	Architect:
Scale: 1:8.25	Pages: 1 OF 1	Drawing #: C1037F17-SUBMITTAL