

Architectural Series, Fire Protection Cabinet, Academy - C1027V10FX2
FE FX2 CABINET, ACADEMY, 3" RT, VERT DUO, CLR ACR, CRS TUB, ALUM DR/TRM, 10 TUB

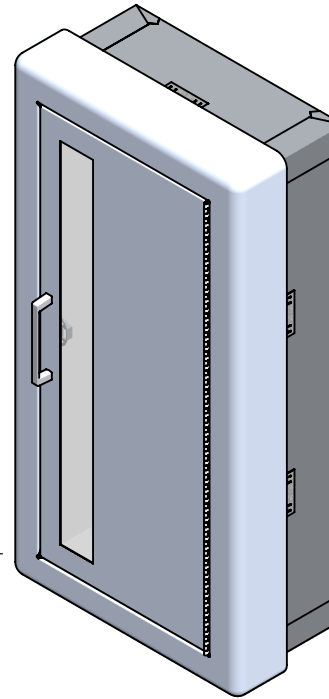
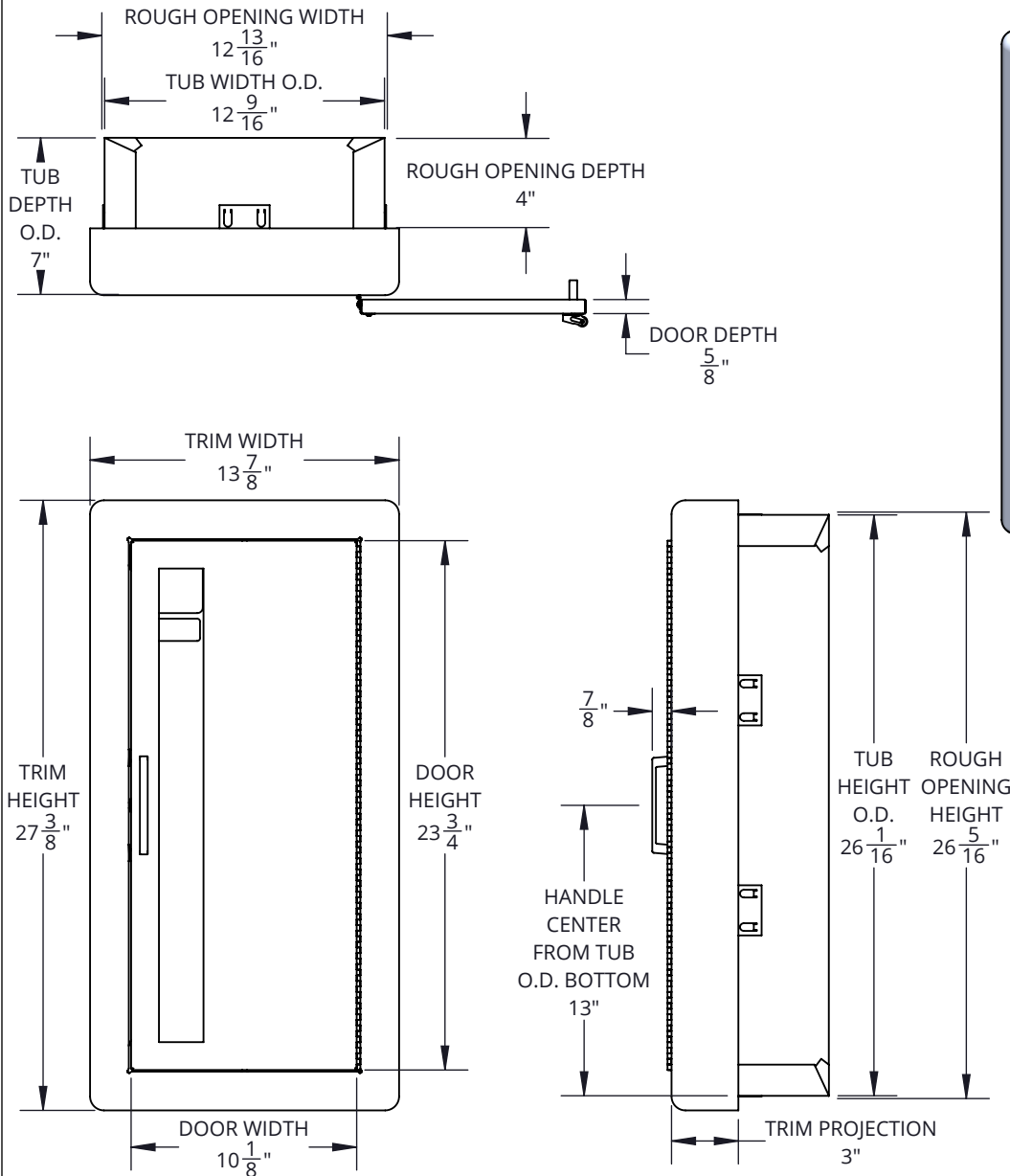

SPECIFICATIONS:

- Tub Material:** 24 gauge galvanized steel
- Trim Material & Style:** 0.050" aluminum, semi-recessed 3" rolled edge
- Door Material & Style:** 0.040" aluminum, vertical duo
- Flange Material:** 22 gauge galvanized steel
- Glazing:** 0.090" clear acrylic (8- $\frac{1}{2}$ " x 22- $\frac{3}{4}$ ")
- Finish:** Anodized door and trim, painted white tub
- Hinge:** Continuous hinge opens door 180 degrees, 20 gauge zinc plated steel
- Hardware:** Zinc plated pull handle, roller catch, glass clips & screws
- Rough Opening:** 12-13/16" x 26-5/16" x 4"
- Fire Rating:** UL classified and labeled up to 2 hours in accordance with UL 1479 (ASTM-E814) and CAN/USC-S115.
- Insulation:** Wool insulation
- ADA Compliant:** Cabinet meets 4" maximum protrusion, locate handle maximum 48" above floor
- Compatible Extinguisher:** Cosmic 2.5lb. - 10lb., Galaxy 2.5lb - 10lb., Mercury 2.5lb. - 5lb., Sentinel 5lb.

MODEL # BREAKDOWN:

- C — Product Line: Fire protection, cabinet
- 10 — Tub Size: 10- $\frac{1}{2}$ " x 24" x 6"
- 2 — Trim and Door Material: Aluminum, anodized finish
- 7 — Trim Style: Semi-recessed 3" rolled edge
- V — Door Style: Vertical duo, pull handle, roller catch
- 10 — Door Glazing: 0.090" clear acrylic
- FX2 — Fire Rated

REPLACEMENT PARTS:

- Tub: TUB-10-7FX2
- Trim: T-1027
- Door: D-102V
- Glazing: G10F10
- Hardware Pack: HPPFUS

MODEL #: C1027V10FX2



800-554-6077
 sales@activarcpg.com
 www.activarcpg.com

9702 Newton Ave S. Bloomington, MN 55431 | Many Locations Nationwide

THE INFORMATION CONTAINED IN THIS DRAWING IS THE SOLE PROPERTY OF ACTIVAR CONSTRUCTION PRODUCTS GROUP, INC. ANY REPRODUCTION IN PART OR AS A WHOLE WITHOUT THE WRITTEN PERMISSION OF ACTIVAR CONSTRUCTION PRODUCTS GROUP, INC. IS PROHIBITED.

Distributor:		Project:
Contractor:		Approved By:
Date:	Quantity:	Architect:
Scale: 1:8.25	Pages: 1 OF 1	Drawing #: C1027V10FX2-SUBMITTAL